



## HP LaserJet 1020 Plus



### Index:

- 1. Covers, panels, and doors**
- 2. Internal assembly**
- 3. PCAs**



## 1-Covers, panels, and doors

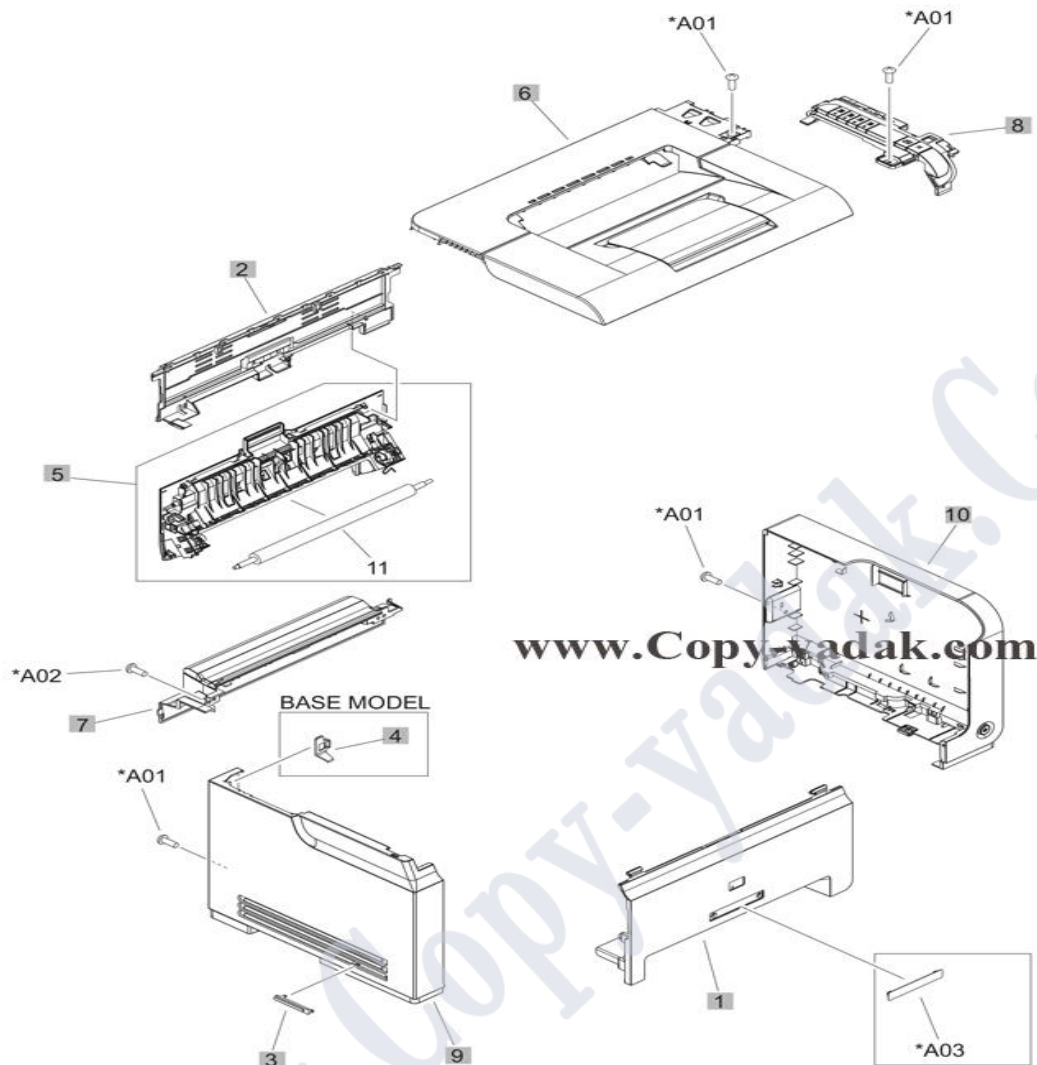

Parts Number		Description
1	RM1-7219-000CN	Door, front (base model)
1	RM1-7275-000CN	Door, front (plus mode)
10	RM1-7232-000CN	Cover, right
11	RM1-7232-000CN	2ND Transfer roller assy.
2	RC2-9834-000CN	Cover, fusing
3	RC2-9866-000CN	Cover, blanking
4	RC2-9867-000CN	Cover, network plug (base model)
5	RM1-7216-000CN	Rear cover/2nd transfer assembly
6	RM1-7217-000CN	Cover, top
7	RM1-7273-000CN	Cover, low-voltage power supply assembly
8	RM1-7273-000CN	Control panel assembly (base model)
8	RM1-7227-000CN	Control panel assembly (plus model)
9	RM1-7231-000CN	Cover, left

## 2-Internal assembly

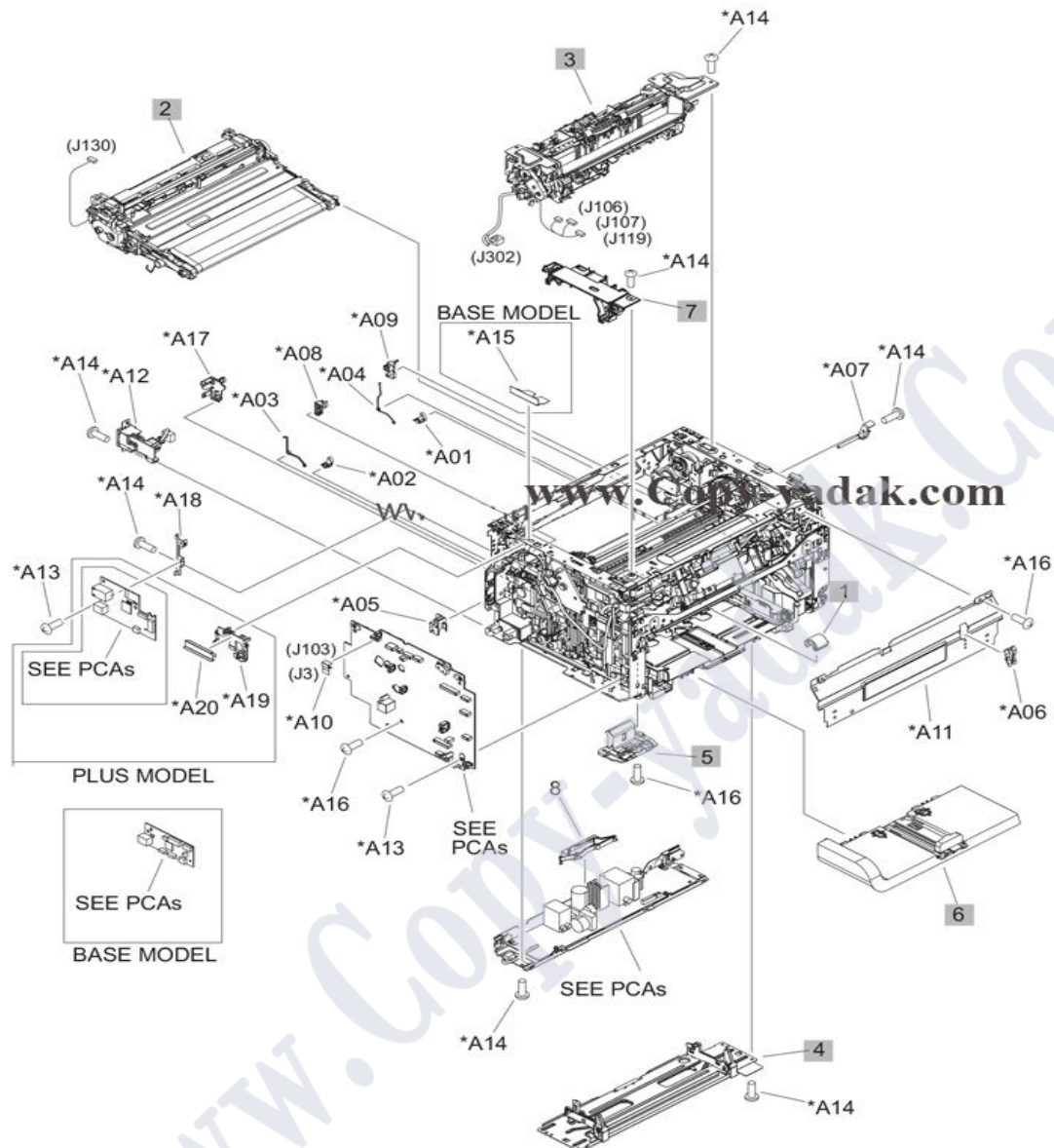

Parts Number		Description
1	RL1-2671-000CN	Roller, pickup
2	RM1-7274-000CN	Intermediate transfer belt assembly (ITB)
3	RM1-7211-000CN	Delivery assembly, fuser (110-127 V)
3	RM1-7269-000CN	Delivery assembly, fuser (220 V)
4	RM1-7213-000CN	Plate, base
5	RM1-7228-000CN	Pad, separation
6	RM1-7276-000CN	Tray, main assembly
7	RM1-7218-000CN	Cover, inner



3-PCAs

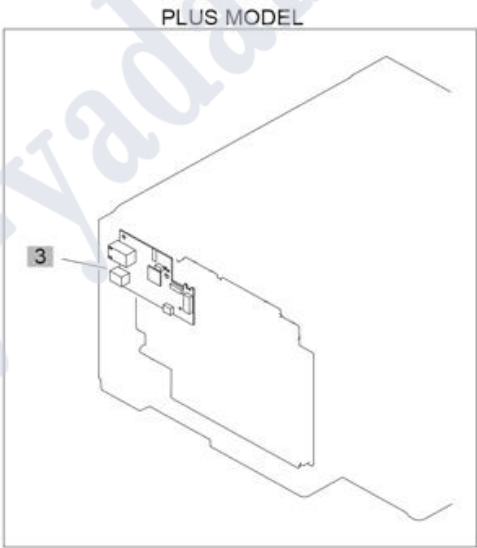
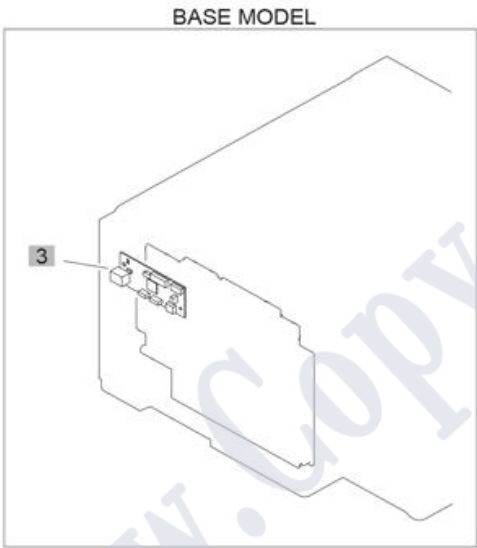
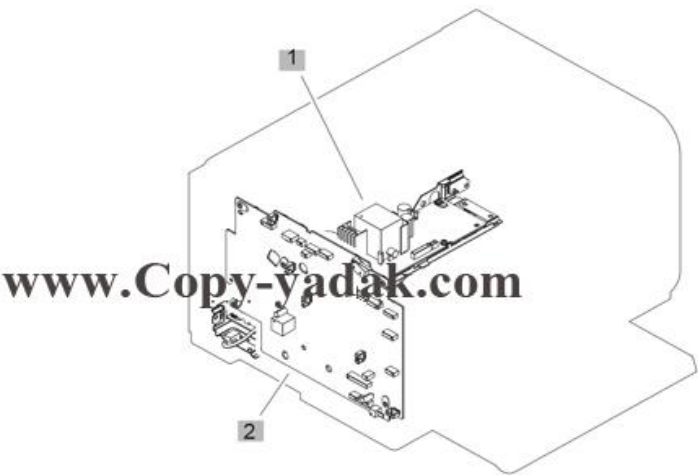

Parts Number Description		
1	RM1-7751-000CN	Power supply, low-voltage (110-127 V)
1	RM1-7752-000CN	Power supply, low-voltage (220/240 V)
2	RM1-7777-000CN	PCA assembly, engine controller
3	CE828-60001	Formatter PCA (base model)
3	CE964-60001	Formatter PCA (plus model)